

IMPORTANT

You should have already received a copy of the Wellington Pre-Installation Information leaflet. This can be downloaded from www.jeld-wen.co.uk if required.

Part M primary access compliance is only achieved if all doors leaves are opened and is dependant on the installation detail used. If in doubt consult your building designer.

All loads are taken on the head track (to ensure smooth, light operation and long life) thereby avoiding troublesome bottom track loading prone to dirt and restriction.

Prior to installing this doorset, inspect for damage and do not proceed to fit if any noticeable damage or defect is evident. This doorset should be stored in a dry flat location before installation.

CAUTION

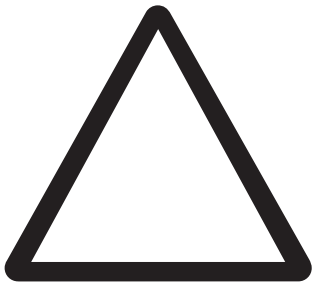

SAFETY: This product needs to be installed by a competent tradesperson with assistance.
Two people are required to carry out the installation, as some components are heavy. The outer frame requires fixing to the supporting structure above the opening. The Lintel **MUST** be capable of carrying the load of the doorset in all conditions. If in doubt check with a structural engineer.

Ref WD_M_0001

Fitting and Fixing Instructions

Wellington Patio Doorset

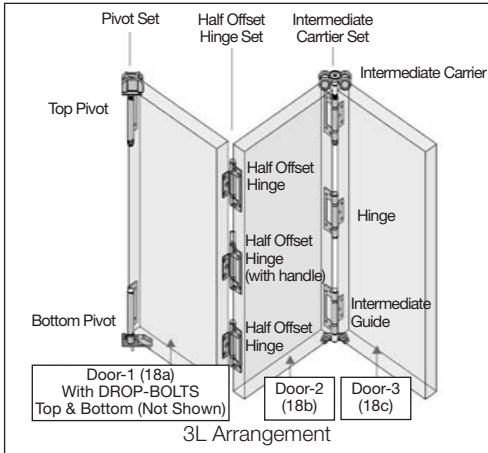

3L Arrangement

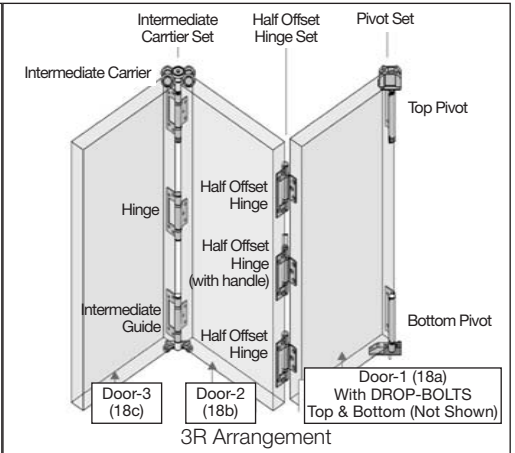

3R Arrangement

Contents

Door 1 Door 1 is the first hung and is to be fitted with the dropbolts. The pivot edge of door 1 is fitted with weatherseal (Aquamac 89).

Door 2 Door 2 is the middle door of the three. Both edges of door 2 are fitted with weatherseal (Aquamac 109).

Door 3 Door 3 is fitted with the multi-point lock and the locking edge of door 3 is prepared for with weatherseal (Aquamac 7066).

Frame Pack Head assembly. Sill assembly. Left-hand jamb assembly. Right-hand jamb assembly. The frame assemblies are fitted with weatherseal 8no 5 x 90mm woodscrews.

Frame Width	1800mm	2100mm	2400mm
Configuration			
3L	1 or 18a 2 or 18b 2 or 18c	1 or 21a 2 or 21b 3 or 21c	1 or 24a 2 or 24b 3 or 24c
3R	3 or 18c 2 or 18b 1 or 18a	3 or 21c 2 or 21b 1 or 21a	3 or 24c 2 or 24b 1 or 24a

Doorset Hardware pack

a) Pivot hinge set

- 1 top pivot hinge
- 1 bottom pivot hinge
- 1 top pivot screw pack
- 1 bottom pivot screw pack

b) Half offset hinge set

- 2 half offset hinge
- 1 half offset hinge c/w handle
- 1 half offset hinge screw pack

c) Intermediate carrier hinge set

- 1 intermediate carrier hinge
- 1 intermediate hinge
- 1 intermediate guide hinge
- 1 intermediate hinge screw pack

d) Dropbolts

- 1 top dropbolt (non-keyed)
- 1 bottom dropbolt (keyed)
- 1 top dropbolt screw pack
- 1 bottom dropbolt screw pack
- 1 dropbolt cups
- 1 blank plate pack including Phillips driver bit and 2 dropbolt blanking plates
- 1 dropbolt keep

e) Handle pack

- 1 handle set
- 1 35/35 cylinder
- 1 screw pack
- 1 centre keep
- 1 centre keep blanking plate
- 2 hook keeps
- 2 hook keep blanking plate

f) Gasket set

g) Head track

h) Aluminium Sill

i) Multi point lock including screw pack

j) Ventilators

- 2 Select vents
- 4 screw cover caps
- 2 external canopies
- 1 screw pack

k) Frame Fixing pack

Frame Fixing Pack

Quantity	Description	Illustration
16	3.5x37 CSK Pozidrive Woodscrew	
8	7mm Brown Masonry Plugs	
10	5x75 self drilling screw CSK Pozidrive	
10	8x100 Nylon Frame Anchor	
8	5x90 CSK Pozidrive Woodscrew	
3	3.5x25 PAN Pozidrive Woodscrew	
10	Brown M6 push-in cover	
8	147x17 Tie Plate	
16	100x24 Wedge Packer (1 to 4mm)	
34	100x24 Flat Packer (3mm)	
34	100x24 Flat Packer (1mm)	

Structural Opening

To ensure correct operation of The Wellington Patio Doorset it is necessary for the top track to be fixed to a suitable structure that is capable of supporting the loads imposed by the doors, glazing and hardware. The Pre-Installation Information Sheet, that you should have already received, gives information relating to these loads.

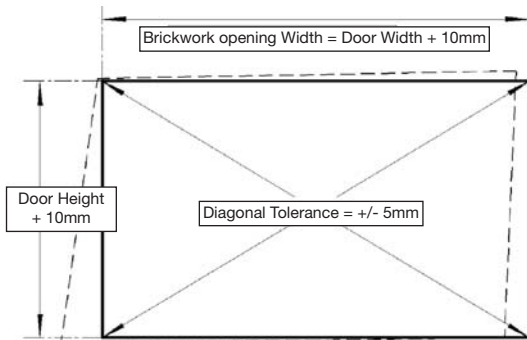

It is recommended that the opening into which the Wellington Patio Doorset is to be installed is 10mm larger in both height and width than the overall doorset sizes that are given in the table.

Module Size	Overall Frame Width	Overall
1800mm	1795mm	2095mm
2100mm	2095mm	2095mm
2400mm	2395mm	2095mm

The horizontal and vertical surfaces should be checked with a spirit level and the diagonals of the opening should be within 5mm of each other.

Preparing the frame for fixings:

Prior to assembling the frame prepare each component for installation by drilling as described below;

Head assembly

The cut-away in the aluminium channel should be at the end where door 1 (with the dropbolts) is to be hung on the top Pivot Hinge.



Sill assembly

If the aluminum section and timber part of the sill are not pre-assembled they should be fixed together as follows; apply a bead of silicon to the rebate in the top of the timber part (as shown) push the timber part into the aluminium part so that it is fully home. Pilot drill, 2.5 x 25mm through the three fixing holes in the underside of the aluminium part fix, from the underside, using 3No. 3.5 x 25 pan head screws.

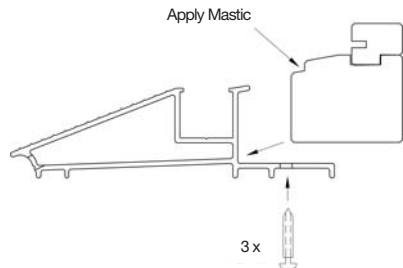

Jamb assemblies

Drill a series of 8mm diameter holes through the jambs, at the positions shown, to receive the 8 x 100 Frame Anchors.

Fitting and Fixing Instructions

Wellington Patio Doorset

Required Dimensions of the Structural Opening

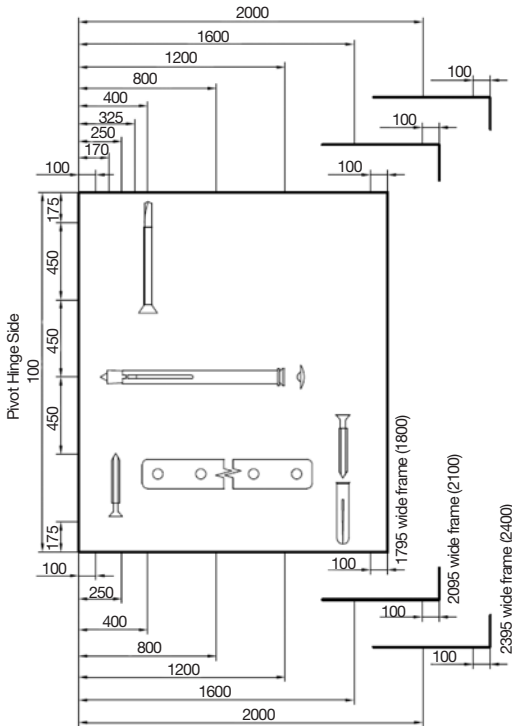

Frame Assembly:

The four assemblies that together form the frame of the Wellington Patio Doorset are fixed together using the 8 No. 5 x 90 woodscrews and the gaskets.

Screw fix the jamb assembly to the head assembly with 2 No 5x90mm woodscrews in each end.

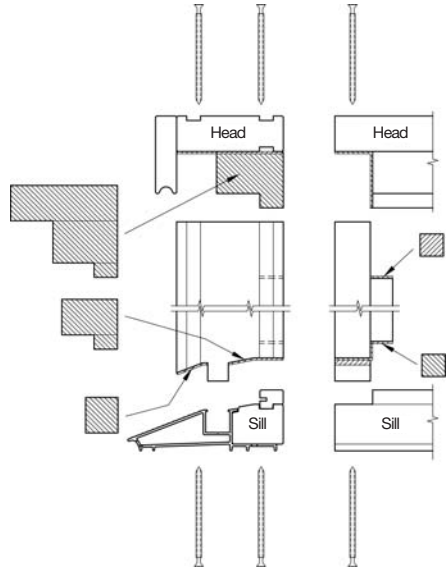

Stick sill-end gaskets either side of the tenon at the sill end of the jamb assemblies and stick a gasket to the sill ends of the stops of the jamb assembly, locate the tenon into the channel in the sill assembly and then screw-fix the sill assembly to the jamb assemblies with 2 No. 5 x 90 woodscrews that pass through the holes in each end of the sill assembly, through the gaskets, and locate into the pilot holes in the ends of the jamb assemblies.

Check that the corners of the frame are square and that the diagonals of the frame measure to within 5mm of each other. If they do not, loosen the screws at the joints, adjust the frame then retighten the joints.

Secure the Tie plates to the underside of the frame using the 3.5 x 37 woodscrews at the positions prepared with pilot holes.

Ensure the tie plates are fixed through both the aluminium and timber profiles.

Fixing Frame in opening

Offer the frame into the structural opening and adjust its position to ensure that the fixing holes in the head track are in the correct position to match the supporting structure (i.e. in the centre of the external flange of a lintel)

Locating the Frame

When the position of the frame is correct place 5mm of packing above each jamb between the head and the top of the structural opening then place packers below the sill until the head packers are tight.

Using a spirit level, check that the head and sill are level, make adjustments as necessary, then pack at each of the sill fixing points ensuring that the sill remains level.

Use the spirit-level to check that the jambs are vertical. Position packers at each of the jamb fixing points ensuring that the diagonals of the frame remain within 5mm of each other.

Fixing Jambs

While the frame is temporarily secured by the packers, and ensuring the frame is not knocked out of position, drill 8mm diameter holes 70mm into the structure either side of the frame through the prepared holes in the jambs.

Insert the frame fixing bolts through the jambs and into the structure and tighten ensuring the jambs are not distorted.

Fixing the Sill

For each of the sill ties locate a suitable fixing point and drill for the 7mm masonry plug then fix the sill ties using the plugs and the remaining 3.5 x 37 woodscrews.

Check once more, that the jambs are vertical, that the head and sill are level and that the diagonals are within 5mm of each other.

Fixing the Head

To use the self-drilling screws to fix the head, it may be beneficial to predrill a lintel with 3.5mm diameter holes using the prepared holes in the head track as a guide.

In order to produce a camber in the head track as shown opposite the fixings to the head need to be fitted in stages reducing the gap between the head and the supporting structure at each stage.

Starting with the two outer fixings offer up the fixing screw and tighten until it is just pulling. DO NOT FULLY TIGHTEN AT THIS STAGE.

At a central fixing point lightly tighten a screw until the head is pulling close to the lintel.

Working from the jambs inwards lightly tighten screws varying the thickness of packing between the head and the lintel creating a slight upwards curve to the head varying from approximately 5mm at each jamb to zero in the middle.

Once the correct curve of the head has been achieved tighten the fixing screws. DO NOT OVERTIGHTEN.

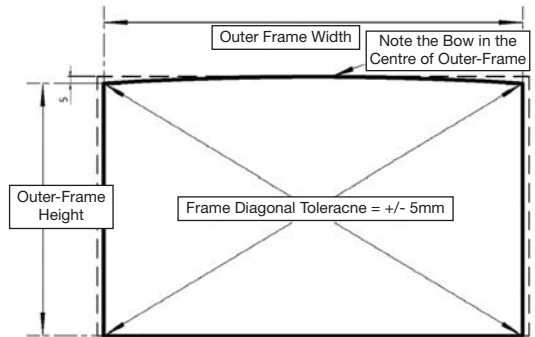

Fitting Keeps and Blanking plates

To complete the frame installation fit the dropbolt cups, keeps and blanking plates.

The dropbolts are fitted to door 1 and so the dropbolt cups should be fitted to the positions nearest to the Pivot Hinge.

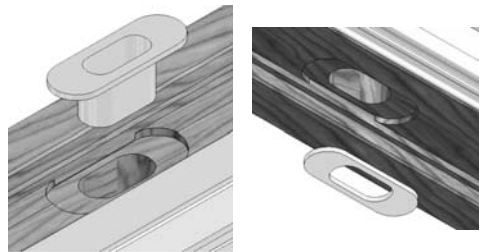

The dropbolt cup blanking plates should be fitted in the remaining positions.

The lock blanking plates are fitted to the jamb next to the Pivot Hinge.

Fitting and Fixing Instructions

Wellington Patio Doorset

The Centre Keep and the Hook Keeps should be fitted to the jamb opposite to the Pivot hinge.

Note: in order to fit the centre keep the timber where the “tang” of the keep is to be located will need to be removed with a chisel.

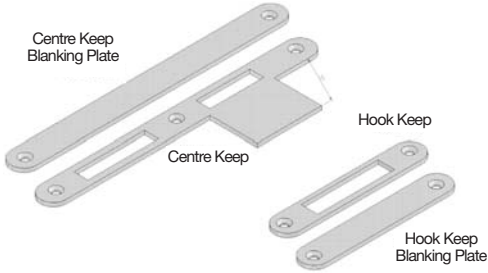

Fitting the doors and door hardware

The pivot hinge set and the intermediate carrier hinge set are reversible and suit both 3L and 3R arrangements. When fitted and make the knuckle of the hinge should be on the outside of the doorset.

The hinges are reversed, by unscrewing the centre pin, rotating the hinge plates and refitting the centre pin.

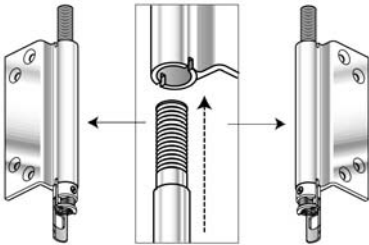

The cut-away in the top track is positioned on the side of the Pivot Hinge. Feed the carrier for the Intermediate Hinge first then fit the Pivot hinge block.

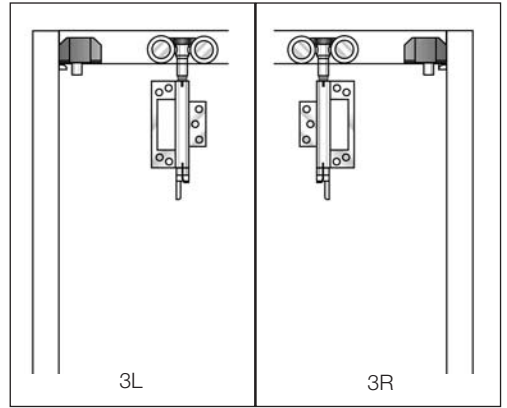
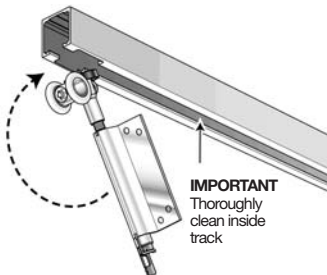

Fitting the Top pivot block (3L arrangement, viewed from outside).

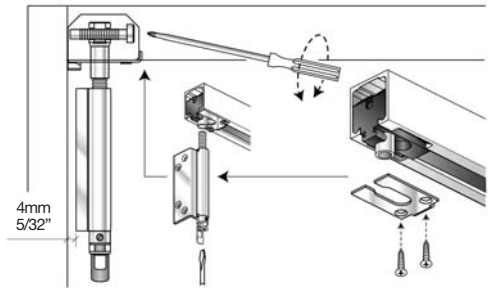

Fitting the bottom pivot block (3L arrangement, viewed from outside).

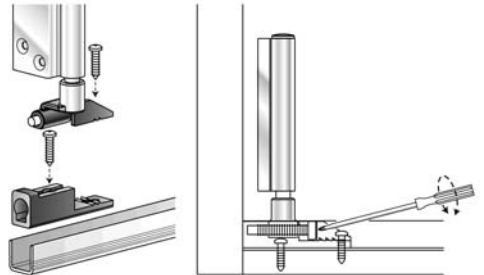

Hanging the doors

The doors are to be hung with the glazing beads facing towards the inside of the building.

Fitting the multipoint lock

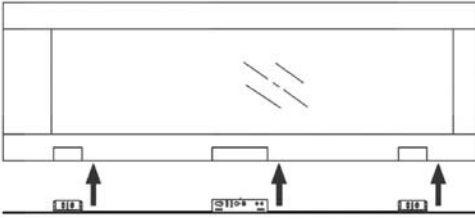

Locate the multipoint lock in the pre-machined cut out on the door leaf and screw in place using the screws provided.

Hanging Door 1

Before attempting to hang door 1 fit the dropbolts. The keyed dropbolt at the bottom and the non-keyed to the top.

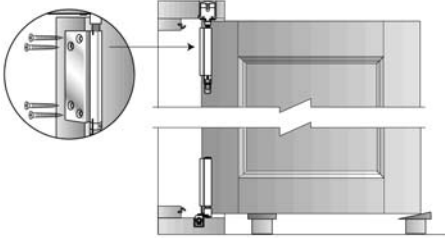

Use the predrilled pilot holes to fix the hinge (screws are provided in the hinge pack)

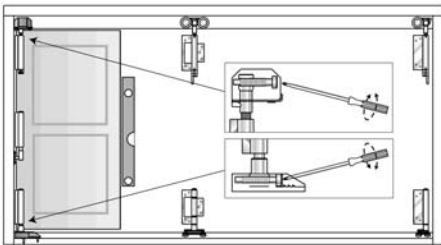

Adjust the top and bottom pivot hinges to ensure door 1 is vertical before attempting to hang door 2.

Hanging Door 2

Remove the weatherseal from the edges prior to fitting hinges. Fit the Half Offset Hinge set to door 1 ensuring the hinge with the handle is in the middle position and the knuckle of the hinges are facing inwards. (opposite to the Pivot hinge set). The small plate of the hinges should be fitted to door 1 and the large plate to door 2.

Hang door 2 to the Half Offset Hinge set fitted to door 1 and also fix the Intermediate Hinge set to the other edge of door 2 ensuring that the large plate of the hinge is fitted to door 2.

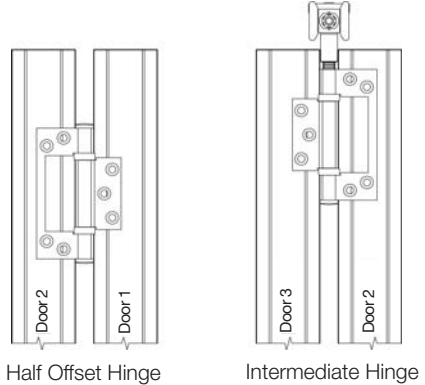

Refit weatherseal to all four grooves in the edges in Door 2. Where seal is interrupted by a hinge plate it should be cut either side of the plate.

Hanging Door 3

Hang door 3 on the Concealed Intermediate Hinge set fitted to door 2. Door 3 should be hung on the small plate of the Intermediate Hinge.

Fitting the handles and lock cylinder

If the handling of door 3 is changed the latch may need to be reversed.

- Release the screw holding the latch
- Remove the latch, reverse and replace
- Refit the holding screw

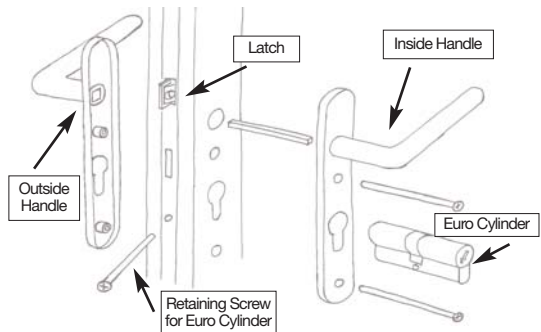

Fitting and Fixing Instructions

Wellington Patio Doorset

Adjusting the doors

Adjustments can be made to the top and bottom pivot hinges and to the top intermediate carrier hinge located in the head track.

The top and bottom pivot hinges can be adjusted to move all three doors sideways between the jambs. It is important to adjust both hinges evenly as uneven movement could effect the load supported by the head track.

The top pivot hinge and the top intermediate hinge can be used to raise and lower the doors. Again, these should be adjusted together to ensure an even distribution of load.

The doors should be adjusted so that there is an even gap at the head, sill and jambs.

The target clearance at the head and sill is 5mm and that at the jambs is 8mm.

When the doors have been adjusted correctly the yellow caps and collars fitted to the top hinges should be removed.

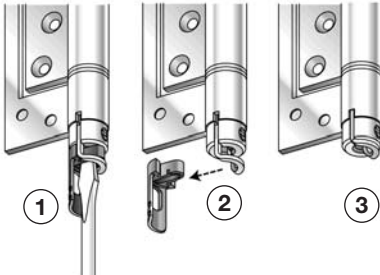
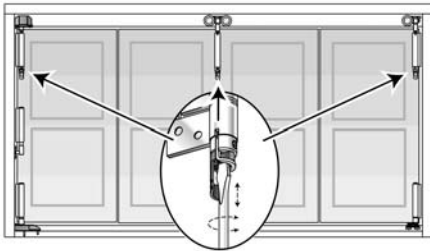

Finishing and Maintenance

Finishing

After finishing the installation of your doorset, check that all the fixings are secure and all the specified dimensions are achieved. It is vital for proper operation and long life of your Patio doorset.

The Wellington Doorset is supplied in 3 specifications;

- 1) Hardwood Unfinished
- 2) Softwood Basecoat stained or primed
- 3) Softwood Factory finished

Softwood factory finished requires no further decoration other than touching up damage that may have occurred during installation,

The hardwood unfinished doorset must be primed or sealed immediately after delivery/ collection and prior to installation. This should be carried out in dry weather conditions. All faces, edges and any cutouts should be suitably sealed immediately after un-wrapping. Before priming or sealing lightly sand off any handling marks and variations caused by exposure and ensure the surface is dust free.

Once primed or sealed final finishing should be carried out as soon as is practically possible no later than one month for stained or 3 months for primed after exposure.

Microporous paints and woodstains are recommended for all exterior products. The manufacturers instructions should be followed. 'Low Build' stains should not be used.

Pigmented translucent finishes generally perform much better than clear. It is recommended that dark coloured stains or paint should be avoided if the doorset is exposed to the full heat of the sun, particularly on south or south west elevations. Dark finishes increase surface temperatures and cause excessive drying out, this can lead to surface deterioration requiring more regular maintenance.

Maintenance

These products must be installed in accordance with accepted good trade practice (and in accordance with supplied instructions where applicable), and maintained in accordance with these procedures or else the warranty shall be void.

A Guarantees

In keeping with our quality policy, JELD-WEN offers the following guarantees on its products. These guarantees are subject to JELD-WEN UK Terms and Conditions of Sale. Defects that are caused in whole or in part by failure to adhere to JELD-WEN UK recommendations relating to storage, handling, installation, decoration, glazing and maintenance, are not covered by these guarantees

- 10 10-year guarantee against manufacturing defects**
- 10 10-year guarantee on insulating glass units**
Only insulating glass units supplied by JELD-WEN UK are covered by this Guarantee, these are stamped and identified accordingly.
- 30 30-year guarantee against fungal attack**
Against rot and fungal attack on all external timber components.
- 10 10 year guarantee on Hi-build factory painted external joinery in accordance with EN927/1-7**
- 6 6 year guarantee on Hi-build factory stained external joinery in accordance with EN927/1-7**

Exceptional wear and tear of hardware through extreme use is not covered. JELD-WEN will accept no responsibility for products cut down in size after receipt, or when utility or structural strength is impaired in fitting or application of hardware.

Hinges, aluminium rails and other hardware fitted must never be painted, and must be kept clean and lightly lubricated at all times. Use Vaseline or neutral oil. Keep rivets and moving parts lightly lubricated. Lubricate at least once a year, in coastal areas and/or places with high pollution, clean and lubricate more often.

The fitting instructions where supplied must be followed and the assembly, fitting procedures described must be strictly adhered to. Copies of product fitting instructions are available for download from www.jeld-wen.co.uk

All joinery shall be installed correctly in accordance with normal trade practices and adequately maintained in service.

All undecorated joinery supplied in the white must be suitably primed or stained without delay after receipt and all joinery supplied primed must receive further coats (undercoat and top coat) of paint within three months of purchase. If primed, and in particular basecoat stain finishes have deteriorated because of prolonged exposure, the surface must be properly prepared and re-primed before finishing. Knotting solution should be applied over any visible knots on primed or part finished painted products. Those products supplied with a basecoat stain need either a second basecoat, or an application of medium to high build stain within 1 month of exposure.

These are the minimum requirements and further finishing coats must be applied to the manufacturers' recommendations to afford full protection.

Take care not to paint over any form of weather stripping, as this will adversely affect their performance.

Any surfaces subsequently cut, particularly those exposing end grains, must be brush coated with preservative and if required for paint finish must also be primed before the joinery is fixed in position in accordance with British Standards or Euro codes.

Standard insulating glass units must not be used in areas of high humidity, e.g. swimming pools or similar. They should also not be used within 300mm from a door or within 800mm of the floor. Contact JELD-WEN if in doubt for your particular installation or refer to Page 08 of JELD-WEN's Timber Window Technical Specification Guide available upon request (Tel 0845 122 2890) or as a download from www.jeld-wen.co.uk

The decorative finish applied to external joinery must be maintained in service and moisture must not be allowed to penetrate into the timber throughout its life.

Fitting and Fixing Instructions

Wellington Patio Doorset

Regular maintenance of the paint or stain finish of the frame is essential for the long-term performance of all the components of your patio doorset. The period between maintenance checks will vary depending on the type of paint or stain finish and also the local conditions for the site. External joinery products must be cleaned at a maximum of six monthly intervals using a mild non-abrasive cleaner and soft cloth. Both internal and exterior faces should be cleaned.

Make regular checks to ensure that any drainage holes, channels and spaces are kept clear. Use a soft flexible brush or pipe cleaner with care to remove obstructions.

Finished joinery is guaranteed against blistering, cracking, flaking or erosion excluding natural resin exudation and movement around knots.

Annual inspection should be made and touching up carried out as necessary in areas of wear and tear (for example, exposed areas of sills or where the paint film has been breached).

Guarantees to the finished product are also on condition that:

- No physical or chemical damage to the doorset or coating has occurred
- No repairs or alterations to the surrounding buildings have occurred which are detrimental to the joinery performance.
- No failure of the coating has occurred caused by failure of ancillary products, or glazing.
- No damage to the coatings has occurred prior to, or during, installation.
- No damage to the coating has occurred, caused by bad maintenance of the building or poor design of the building.

Further installation and handling information is available by downloading a copy of JELD-WEN's Timber Windows Technical Specification Guide at www.jeld-wen.co.uk

JELD WEN[®]

WINDOWS & DOORS

To register under our priority guarantee scheme, please complete and return the form below. Registered installations will be given priority by our customer care team and no call-out charge will be made in the event of service calls. Any manufacturing defects will be repaired free of charge. Installation defects will be charged for parts and labour only.

1. Builder / Installer's name and address (if applicable)

2. Owner / occupier's name

3. Installation address

4. Product installed: Canberra / Wellington (delete as applicable)

5. Date of installation _____

6. Did you understand the fitting instructions? Yes / No

7. Was the product decorated before installation / assembly? Yes / No

8. Were parts clearly identifiable and correct? Yes / No

If "no" please give details:

9. Have you any comments to add?

Thank you for your assistance. We trust you are pleased with your Patio Door Set.

This information is required for guarantee registration and product improvement only. It will not be passed to any third party. Your statutory rights are not affected.

Fitting and Fixing Instructions

Wellington Patio Doorset

JELD-WEN UK LTD
Snow Hill
Melton Mowbray
Leicester LE13 1PD

T: 01664 484500
F: 01664 484502